

**FOR LEASE**

# Small Storefront

2799 Southwestern Blvd., Orchard Park, NY 14127

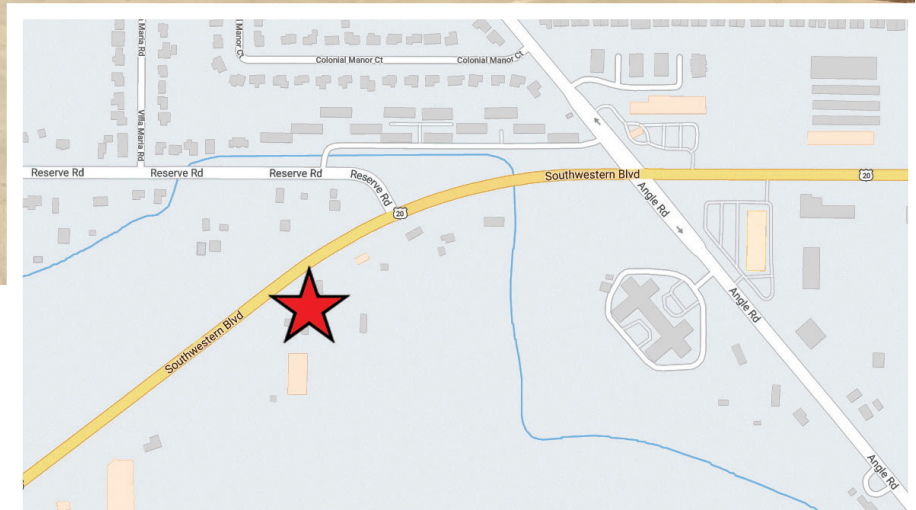

## HIGHLIGHTS

- 1,200 sq. ft. available in attractive, all brick, neighborhood plaza
- Conveniently located between Michael Rd. and Angle Rd.
- Many uses from professional office to retail business
- Convenient parking
- Additional storage included
- Local landlord



344 Delaware Ave, Suite 200, Buffalo, NY 14202

The information submitted herein is not guaranteed. Although obtained from reliable resources, it is subject to errors, omissions, prior sale and withdrawal from the market without notice. Broker has made no investigation and makes no representation of the property.

**Robert Culm**

Associate Real Estate Broker

716.812.9831

RobertCulm@HannaCRE.com